

Art.-Nr./Item no./N° d'Art. 670051-V08

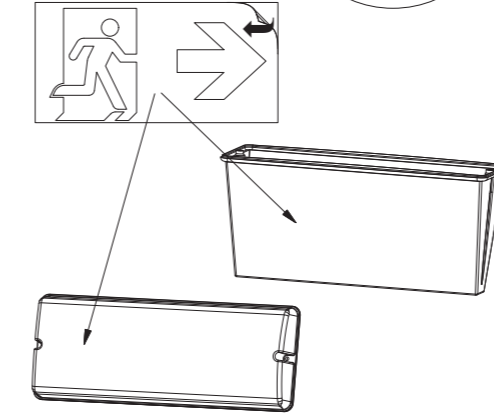
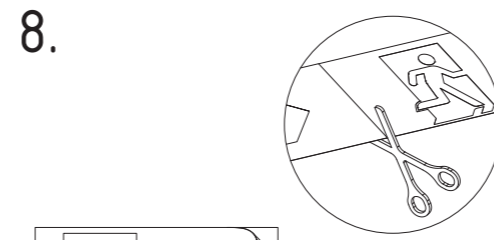
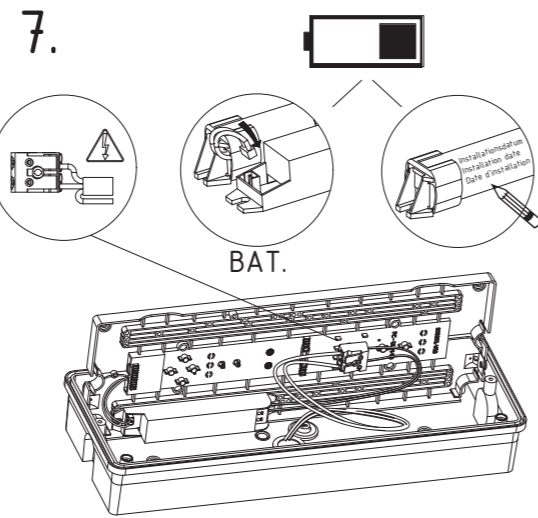
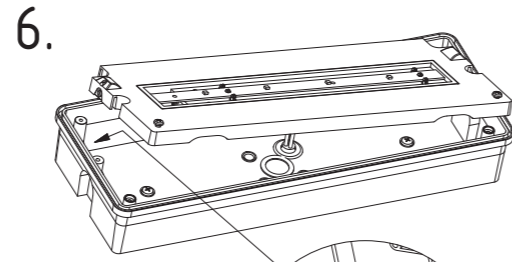
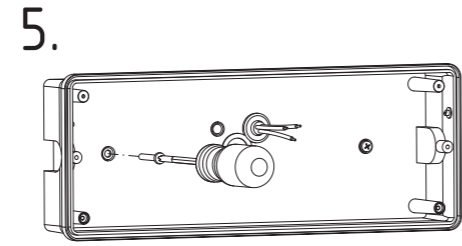
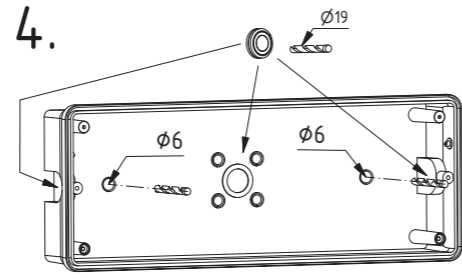
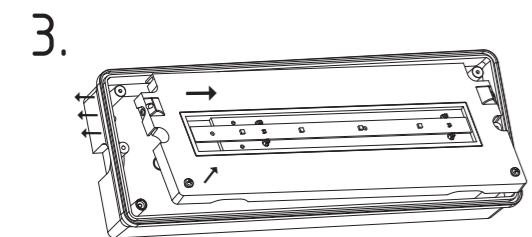
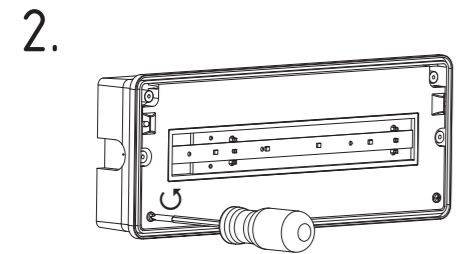
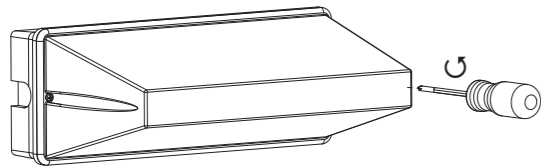
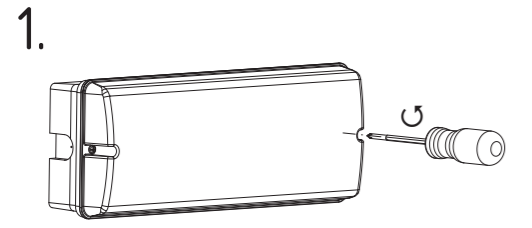

9. 2. → 1.

Leuchtmittelwechsel
 Illuminant change
 Agent lumineux variation

10. → 1.

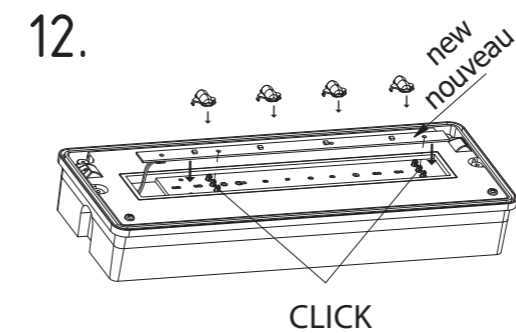
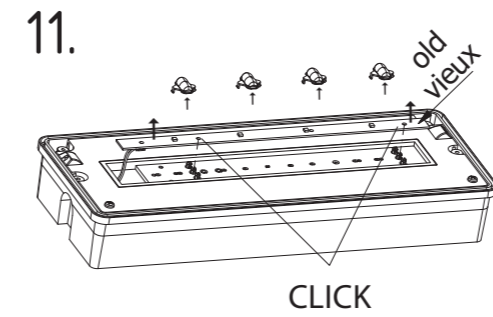

13. → 1.

Gehäuseausführung / Casing design / Configuration logement
370 x 140 x 90 mm

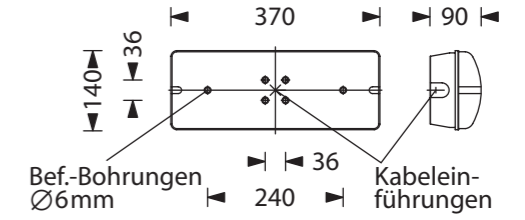

Gehäuseausführung / Casing design / Configuration logement
370 x 217 x 140 mm

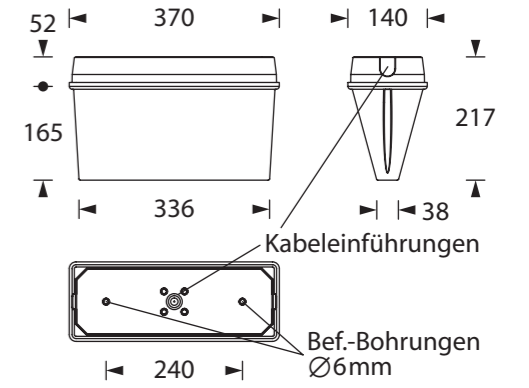

Kabeleinführung
 Cable entry guide
 Introduction de câble
 Bef. Bohrungen
 existing boreholes
 Perçages existants

